

Starlink Flat High Performance Pipe Adapter

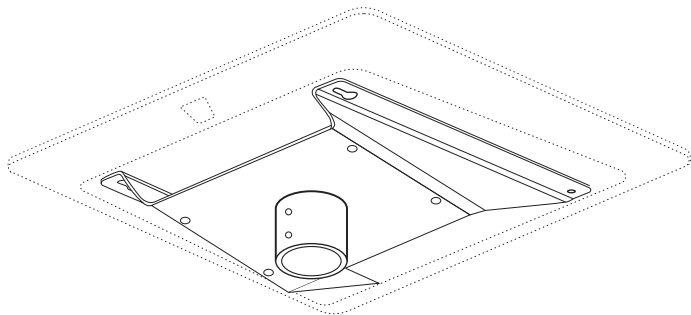

STARLINK

NOTES & WARNINGS

If you are uncomfortable with any part of the installation process, do not attempt – contact a professional to install your Starlink. Starlink is not responsible for injury or damage caused to property due to the installation process.

Please be aware that inclement weather (e.g., heavy rain, snow, or wind) can affect your satellite internet connection, potentially leading to slower speeds or a rare outage.

The Starlink will detect and melt snow that falls directly on it; however, accumulating snow around the Starlink may block the field of view. We recommend installing Starlink in a location that avoids snow build-up and other obstructions from blocking the field of view.

Your mount should be mounted on a horizontal surface, giving your Starlink an 8° tilt to prevent rain buildup. Mounting your Starlink in a vertical position (e.g., on the side of your chimney), will not allow it to operate.

INSTALLATION CONDITIONS

WARNING! The Starlink router and power supply are rated for both indoor and outdoor use. See Regulatory Notices in your Starlink internet kit for information on environmental specifications of your Starlink and accessories.

Kit Installation for Use on Moving Vehicles

Take extra care if installing a Starlink being used on a moving vehicle or vessel. Ensure that the mount is installed on a structurally sound, horizontal surface away from other equipment to give your Starlink a clear view of the sky. Equipment falling on the road or off a vessel due to poor installation practices can cause serious accidents resulting in bodily injury, do not mount the Starlink on any vehicle or vessel if it is not stable, or if it cannot be properly secured as described in this guide. Ensure the installation on vehicle or vessel is compliant with local Department of Transportation or maritime regulations.

Satellite Systems Co-Location Notice

Users should maintain a minimum separation distance of 14' (4 m) between satellite antennas.

SAFETY NOTICES

WARNING! To reduce the risk of injury, electric shock, or fire, follow basic safety precautions, including:

- Make sure the product's power is disconnected before accessing, moving, or installing the Starlink (aka "Dishy McFlatface").
- Plug the power cord into an AC outlet that is easily accessible at all times. If the power cord has a 3-pin attachment, plug the cord into a grounded (earthed) 3-pin outlet.
- Only use the AC adapter and power cord provided with the system or purchased from SpaceX.
- Do not operate this product with a damaged power cord set. If the power cord is damaged, replace before using this product.
- During operation, do not allow the AC adapter to contact skin or a soft surface, such as carpet/rug or clothing. The product and the AC adapter comply with the user-accessible surface temperature limits defined by applicable safety standards.
- Avoid using this product during an electrical storm. There is a remote risk of electric shock from lightning. Do not operate this product if you notice crackling, hissing, popping sounds, a strong odor, or smoke coming from any parts of the system. Turn off the system, disconnect from power source, and contact Starlink technical support for assistance.

WARNING! To avoid injury to persons and damage to property when drilling, take caution and follow basic safety procedures, including:

- Wear appropriate eye, hand, and face protection.
- Avoid studs, electrical wiring, and water lines when drilling. Drilling into any of these can lead to fire, shock, injury, or death.
- Drill at a slight downward angle from the structure interior to the structure exterior and thoroughly apply sealant. Improper drilling and sealing may lead to water and/or bug intrusion and/or damage.

LIGHTNING PROTECTION

If Starlink is used in a lightning-prone area, an external lightning protection system (lightning rod, ground rod, surge protector, etc.) may reduce product susceptibility to lightning. For added protection during a lightning storm, or when it is left unattended and unused for long periods of time, unplug the product from the wall AC outlet and disconnect the antenna cable. This may prevent damage to the product from lightning and power line surges.

The warranty does not cover damage due to:

- Lightning, electrical surges, fires, floods, hail, windstorms, earthquakes, meteors, solar storms, dinosaurs or other forces of Nature.
- Accident, misuse, abuse or alterations.
- Improper or neglected maintenance.

For more safety, regulatory, labeling, and disposal information, refer to the Regulatory Notices in the main internet kit. The information contained herein is subject to change without notice. SpaceX shall not be liable for technical or editorial errors or omissions contained herein.

SETUP



1. Download the Starlink app on your phone.
2. Before installation, use the "Check for Obstructions" tool in the app to identify the best location for uninterrupted service.
3. Setup your Starlink.
4. After connecting, confirm your setup location is obstruction free by reviewing the data coming from your Starlink.
5. Additional app features: customize settings, receive updates, trouble shoot issues, and contact Support.

SETUP

Box Contents

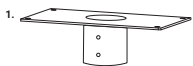

Pipe Adapter



1/4-20 3/4" Machine
Screws (x4)



1/4-20 9/16" Machine
Screws (x6)



Lock Nuts (x4)



Washers (x4)

Additional Items Needed

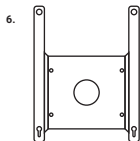

Wedge Mount Kit



5/32" Hex Key

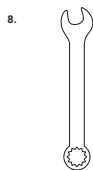

7/16" Wrench

Instructions

1. Insert the 3/4" machine screws with plastic washers through the bottom of the Wedge Mount.

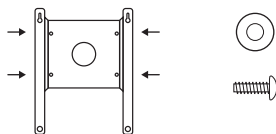

2. Place the Pipe Adapter into the Wedge Mount. All four machine screws should be through the two mounts.

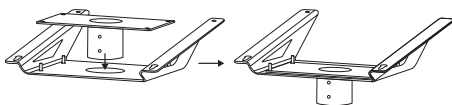

3. Place a washer onto each machine screw, followed by a lock nut. Tighten until the head of the machine screw is flush with the surface of the mount and at least tip of the machine screw is above the lock nut.

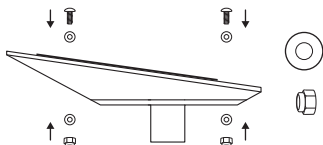

4. Apply thread locker from Wedge Mount Kit to the 9/16" machine screws, then insert them from Pipe Adapter and turn once only to engage threads. Do not completely tighten the machine screws. Place the mount onto the installed pipe.

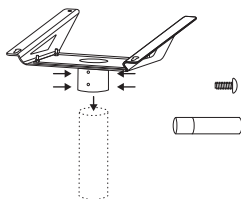

5. Tighten the 9/16" machine screws while holding the mount at desired position on the installed pipe.

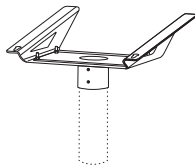

STARLINK

Starlink
Flat High Performance Pipe Adapter

starlink.com
©2022. Space Exploration Technologies Corp.

01697660-013

